

Iowa Site Inventory Form

State Historic Preservation Office

(January 2016)

State Inventory Number: 44-02272 New Supplemental

9-Digit SHPO Review & Compliance (R&C) Number: _____

Non-extant Year: _____

Read the Iowa Site Inventory Form Instructions carefully, to ensure accuracy and completeness before completing this form. The instructions are available on our website.

• **Property Name**

A) Historic name: St. Michael's Episcopal Church

B) Other names: 2023 downtown survey # DT-131

• **Location**

A) Street address: 202 E. Washington St

B) City or town: Mount Pleasant (Vicinity) County: Henry

C) Legal description:

Rural: Township Name: _____ Township No.: _____ Range No.: _____ Section: _____ Quarter: _____ of Quarter: _____

Urban: Subdivision: Original Block(s): 17 Lot(s): Lot 1 - E 1/2 - also E 1/2 Lot 2

• **Classification**

A) Property category: *Check only one*

- Building(s)
- District
- Site
- Structure
- Object

B) Number of resources (within property):

<i>If eligible property, enter number of:</i>		<i>If non-eligible property, enter number of:</i>	
Contributing	Noncontributing		
<u>1</u>	Buildings	<u>—</u>	Buildings
<u>—</u>	Sites	<u>—</u>	Sites
<u>—</u>	Structures	<u>—</u>	Structures
<u>—</u>	Objects	<u>—</u>	Objects
<u>1</u>	Total	<u>—</u>	Total

C) For properties listed in the National Register:

National Register status: Listed De-listed NHL NPS DOE

D) For properties within a historic district:

- Property contributes to a National Register or local certified historic district.
- Property contributes to a potential historic district, based on professional historic/architectural survey and evaluation.
- Property *does not* contribute to the historic district in which it is located.

Historic district name: Mt Pleasant Downtown Historic District Historic district site inventory number: 44-02280

E) Name of related project report or multiple property study, if applicable:

MPD title Intensive Level Historical and Architectural Survey of Downtown Mt Pleasant, Iowa Historical Architectural Data Base # HADB-02986

• **Function or Use** *Enter categories (codes and terms) from the Iowa Site Inventory Form Instructions*

A) Historic functions

06A01: RELIGION / church

B) Current functions

06A01: RELIGION / church

• **Description** *Enter categories (codes and terms) from the Iowa Site Inventory Form Instructions*

A) Architectural classification

06E: LATE 19th CEN / EARLY 20th CEN

REVIVALS / Late Gothic Revival

B) Materials

Foundation (visible exterior): 04C: Limestone

Walls (visible exterior): 03: Brick

Roof: 05: Metal

Other: _____

C) Narrative description *SEE CONTINUATION SHEETS, WHICH MUST BE COMPLETED*

• **Statement of Significance**

A) Applicable National Register Criteria: *Mark your opinion of eligibility after applying relevant National Register criteria*

- Criterion A: Property is associated with significant events. Yes No More research recommended
Criterion B: Property is associated with the lives of significant persons. Yes No More research recommended
Criterion C: Property has distinctive architectural characteristics. Yes No More research recommended
Criterion D: Property yields significant information in archaeology/history. Yes No More research recommended

B) Special criteria considerations: *Mark any special considerations; leave blank if none*

- A: Owned by a religious institution or used for religious purposes. E: A reconstructed building, object, or structure.
 B: Removed from its original location. F: A commemorative property.
 C: A birthplace or grave. G: Property less than 50 years of age or
 D: A cemetery achieved significance within the past 50 years.

C) Areas of significance

Enter categories from instructions

29: Social History

02: Architecture

D) Period(s) of significance

E) Significant dates

Construction date

1865-66 *check if circa or estimated date*

Other dates, including renovations

1904, 1916, 1917

F) Significant person

Complete if Criterion B is marked above

G) Cultural affiliation

Complete if Criterion D is marked above

H) Architect/Builder

Architect

Builder/contractor

I) Narrative statement of significance **SEE CONTINUATION SHEETS, WHICH MUST BE COMPLETED**

• **Bibliography** *See continuation sheets for the list research sources used in preparing this form*

• **Geographic Data** *Optional UTM references* *See continuation sheet for additional UTM or comments*

Zone	Easting	Northing	NAD	Zone	Easting	Northing	NAD
1				2			
3				4			

• **Form Preparation**

Name and Title: Rebecca Lawin McCarley / research by Bob Mueller Date: March 28, 2024

Organization/firm: SPARK Consulting / Mt Pleasant HPC E-mail: sparkconsulting@octaspark.com

Street address: 1630 Park Ave SE Telephone: 319-200-9767

City or Town: Cedar Rapids State: IA Zip code: 52403

• **ADDITIONAL DOCUMENTATION** *Submit the following items with the completed form*

A) For all properties, attach the following, as specified in the Iowa Site Inventory Form Instructions:

- 1. Map** of property's location within the community.
- 2. Glossy color 4x6 photos labeled** on back with property/building name, address, date taken, view shown, and unique photo number.
- 3. Photo key showing each photo number on a map and/or floor plan, using arrows next to each photo number to indicate the location and directional view of each photograph.**
- 4. Site plan** of buildings/structures on site, identifying boundaries, public roads, and building/structure footprints.

B) For State Historic Tax Credit Part 1 Applications, historic districts and farmsteads, and barns:

See lists of special requirements and attachments in the Iowa Site Inventory Form Instructions.

State Historic Preservation Office (SHPO) Use Only Below This Line

The SHPO has reviewed the Site Inventory and concurs with above survey opinion on National Register eligibility:

- Yes No More research recommended
 This is a locally designated property or part of a locally designated district.

Comments: _____

SHPO authorized signature: _____ Date: _____

Iowa Site Inventory Form
State Historic Preservation Office
Continuation Sheet

Site Number: 44-02272
Related District Number: 44-02280

Page 1

St. Michael's Episcopal Church	Henry
Name of Property	County
202 E. Washington St	Mount Pleasant
Address	City

7. Narrative Description

This is a Gothic Revival church that was built as a frame structure in 1865-66 and clad in brick veneer in 1917. The rear additions were also added to the church in 1904 and in 1916, both of which were also clad in brick veneer in 1917. The granite cornerstone to the right/west of the entry vestibule notes "St. Michael's Episcopal Church, 1856 - 1917." Thus, the overall current appearance of the church dates to the work completed by 1917. The steeple was added to the building in 1987, replacing an earlier simple cross at the peak of the roof. Metal roofing was later installed on the gable roof. The stone foundation was replaced with a new concrete foundation in 2019.

The church faces E. Washington St to the north. A concrete ramp and steps lead up to the main entry, which is located in a Gothic (pointed) arch opening in the gable-roof entry vestibule. The sides of the entry vestibule have Gothic arch stained glass windows. The Gothic arch window opening above the entry vestibule is composed of two smaller Gothic arch windows with a circular center/top window. The main gable of the church and the entry vestibule have small brackets under the eaves. The east and west sides are identical, with five stained glass Gothic arch windows separated by brick buttresses. Brick buttresses are also found on the corners as well. The stained glass windows are long lancet type windows with rounded tops that come to a sharp point fitted with stained glass in a style that dates back to the Middle Ages. The majority of the windows are composed of intricate patterns, rather than portraits. They are stencils in clear glass, which is a very traditional window dating back to medieval France, per Ron Boward of Bovard Studios in Fairfield ("History of St. Michael's Episcopal Church, Mt Pleasant, Iowa"). The rear/north elevation of the original building is covered by the rear additions. The gable-roof addition at the southeast rear corner of the church was completed in 1904. The north side has a Gothic arch opening that has been bricked-in. The east side has two small one-over-one-light double-hung windows and three larger one-over-one-light double-hung windows, with a basement window under this set. The south side has two one-over-one-light double-hung windows and a centered basement window with glass block. The 1916 addition consists of a gable-roof section at the southwest rear corner of the church, providing balance with the earlier addition, and a center shed-roof section between the gable-roof sections. The north elevation of the addition extends beyond the corner of the original building, and it has a double-door entry with a gable-roof hood. The west elevation has the basement level at ground level due to the slope of the site. An entry with a shed-roof hood and two windows with glass block are found on the basement level on the south portion of the west side of the addition. There are three one-over-one-light double-hung windows on the main level. The south side has three pairs of one-over-one-light double-hung windows, with basement windows with glass block under them. The gable of this addition is slightly taller than the earlier addition, with a Gothic arch vent in the peak.

8. Narrative Statement of Significance

St. Michael's Episcopal Church appears to be eligible for listing on the National Register of Historic Places as a contributing building within the potential Mount Pleasant Downtown Historic District. Churches were historically built on the edges of the commercial core of the downtown, with this one constructed on the block east on Washington in 1865-66. Similarly, the former Methodist Episcopal church sits on the block east of the square to the north on E. Monroe. The frame church was clad in brick veneer with a significant rear addition for the parish house in 1917. The edge of the commercial development extended east on Washington to the north side of this block in the 1930s. The church has retained its location on this site

Iowa Site Inventory Form
State Historic Preservation Office
Continuation Sheet

Site Number: 44-02272
Related District Number: 44-02280

Page 2

St. Michael's Episcopal Church	Henry
Name of Property	County
202 E. Washington St	Mount Pleasant
Address	City

and relationship to the commercial development of the downtown from the 19th century to the 20th century. St. Michael's Episcopal Church retains sufficient integrity to convey its significance as a historic building in a historic district.

Based on research and evaluation conducted to date, St. Michael's Episcopal Church appears to be potentially individually eligible for listing on the National Register of Historic Places under Criterion A and/or C. Further research and assessment of the interior features and modifications would be required for a full evaluation of the individual eligibility of the building.

Developmental history of property

St. Michael's Episcopal Church was constructed in 1865-1866. Rear additions were constructed around 1900 and in 1916. In 1917, the original frame church and the additions were clad in brick veneer.

The local Protestant Episcopal Church was organized on September 12, 1856, as St. Michael's Parish (*History of Henry County* 1879: 525). An earlier frame church building was bought in 1858 from the Presbyterian Church, who were building a new church, and it was moved to their lots on W. Henry and Jackson. The Protestant Episcopal Church was listed at the corner of Madison (Henry?) and Jackson in the 1859-60 county directory, with Rev. F.E. Judd. The *Home Journal* noted in February 1865: "The Protestant Episcopal congregation have a small building which is inadequate to their wants, and they propose to erect a handsome edifice the coming season. During his recent trip East, the Rev. Mr. Stout secured a little over \$1,000 in aid of this object, with a promise of considerably more..." ("Churches in Mt. Pleasant," *Mt. Pleasant Home Journal*, February 4, 1865, 3). In May 1865, the old Episcopal church on W. Henry was sold to the newly organized African Methodist Episcopal church. A lot had been purchased on E. Washington St for the new Episcopal church, with the congregation using the Universalist church for services until the new building was completed ("Sales," *Home Journal*, May 5, 1865, 3).

Per church history, Colonel John Randolph donated the land where the current church stands to the church for the purpose of building a new church in 1865. The cornerstone of the current church was laid in 1865. It was a frame structure, without the parish hall or brick veneer. The design reflected the Gothic Revival style popular for church buildings in this period. It has buttresses on the exterior walls (common in such a design) and stained-glass windows. The quality of the workmanship is reflected in the unfinished upper level which shows that wooden pegs, rather than nails were used in the construction. Due to the design, the acoustics are excellent for worship. The majority of the money for the new building was obtained wealthy residents and Episcopal parishes in the East and England ("History of St. Michael's Episcopal Church, Mt Pleasant, Iowa").

The church was opened for services in the fall of 1866. It was not formally dedicated until the loan for construction had been entirely paid ("History of St. Michael's Episcopal Church, Mt Pleasant, Iowa"). The last of the debt was paid in early September 1869 due to the ongoing efforts of Rev. C.B. Stout, who had been rector of the church for the last 5 ½ years. The church was worshipping in a small, inconvenient building on Henry St when he arrived, and he determined to make an effort for a new church building. The church was successfully completed in 1866, but he continued his efforts to pay off the debt on the building. Due to his health, he resigned as rector in September 1869 once the debt had been paid,

Iowa Site Inventory Form
State Historic Preservation Office
Continuation Sheet

Site Number: 44-02272
Related District Number: 44-02280

Page 3

St. Michael's Episcopal Church	Henry
Name of Property	County
202 E. Washington St	Mount Pleasant
Address	City

accepting a position as financial agent for Griswold College in Davenport ("A Good Work Done," *Mt Pleasant Journal*, September 10, 1869, 8; "Out of Debt," *Henry County Press*, September 15, 1869, 3).

The 1867 city directory lists the Protestant Episcopal Church on the south side of Washington, one door east of Adams St. The 1869 birds-eye of Mt Pleasant shows the gable-front church with an entry vestibule, no steeple, and five windows on the side. It has a gable-roof rear section perpendicular to the church that extends past the southeast corner. A 1 ½ story house is on the property to the west. The Episcopal Church was noted in January 1876 as occupying a Gothic frame building on E. Washington ("Religious and Benevolent," *The Free Press*, January 6, 1876, 6). Per the 1888 county history, the church was built at a cost of \$6,000, noted for its "very neat and attractive appearance." It had a fine alter set, vases, and cross presented to parish by Hon. Hamilton Fish (*Portrait and Biographical Album of Henry County 1888*: 672). The 1893 city directory lists St. Michael's Episcopal Church on E. Washington with D.C. Howard as rector.

The 1899 Sanborn fire insurance map is the first one to include this block. It shows a frame church building with a small front vestibule and a one-story rear section offset to the east. It is noted as St. Michael Episcopal Church, and it is heated by stoves and has gas lights. A 1 ½ story frame house sits on the property to the west, which is numbered as 200 E. Washington St.

Several improvement projects were completed on the church from 1898 to 1905, per church history. The chancel was remodeled. A Sunday school room measuring 22 x 26 feet was added to the church with funds donated by Mrs. Twinting, her daughters, and Captain Warren Beckwith. Three years later, a pipe organ was installed with money donated by the Beckwith family ("History of St. Michael's Episcopal Church, Mt Pleasant, Iowa").

Newspaper articles note that a parish room (the Sunday School room) was constructed in summer 1904 at the southeast corner of the church. It was noted in December 1904 as a sunny, cheery room with carpet measuring 25 by 28 used for church purposes, but not in connection with regular church service. It was a convenient place for choir rehearsals, church bazaars, socials, and other similar gatherings. The church recently received a gift from a member for carpet for the main auditorium. A bazaar was held in December 1905 by the St Michael's Guild for raising funds for a new pipe organ for the church. A member had offered to pay for half of the \$1600, if the church raised the remainder ("Episcopal Bazaar," *Mt Pleasant Daily News*, December 19, 1904, 3). The new pipe organ arrived in April 1905, installed in time for Easter Sunday. The majority of the \$1600 for the organ was raised by the Episcopal Guild. It was run by water motor, with Miss Emily Beckwith noted as the organist for several years ("New Pipe Organ Here," *Mt Pleasant Daily News*, April 19, 1905, 3).

The 1909 Sanborn map shows the same footprint for the frame church as the 1899 map, with the one-story rear section shown as incorporated into the main footprint. A one-story frame rear addition extends to the rear of the southeast corner of the original rear section. The same 1 ½ story frame house is on the property to the west.

Per church history, Miss Emma Schwenker and Mrs. F. W. Harmayer purchased and donated this house to the west of the church to the church for the purposes of a rectory ("History of St. Michael's Episcopal Church, Mt Pleasant, Iowa"; "St. Michael's Parish organized in 1856," *Mt Pleasant News*, January 27, 1973, 4). Transfer books show that the west half of Lots 1 and 2 in Block 17 were sold by Nina A. Howe

Iowa Site Inventory Form
State Historic Preservation Office
Continuation Sheet

Site Number: 44-02272
Related District Number: 44-02280

Page 4

St. Michael's Episcopal Church	Henry
Name of Property	County
202 E. Washington St	Mount Pleasant
Address	City

and husband to Mary Bird Abbe and Nota M. Abbe on December 29, 1908. The property was then transferred by William Stewart, referee, to the Vestry of St. Michael's Episcopal Church on May 26, 1909.

Rev. W.T. Jackson is listed as rector of the Episcopal Church in the 1911-12 county directory. The new Henry County Courthouse was completed in the center of the block to the west in summer 1914.

Improvements were completed for the Episcopal church property from late 1915 to spring 1916. By July 1916, the new parish rooms were completed and in use. The rectory had also been improved. Work on the exterior brick veneer was anticipated to start in fall ("The Bystander's Notes," *Mt Pleasant Daily News*, July 15, 1916, 2). In October 1917, the "pretty little Episcopal church of St. Michael's" on E. Washington was packed on Sunday morning for a dedicatory service for their recent improvements on the exterior, which was the installation of the brick veneer. The editor noted: "It is now one of the prettiest churches in this small 'city of churches'" ("Dedicatory Services," *Mt Pleasant Weekly News-Journal*, October 31, 1917, 1). These improvements were added due to the efforts of the congregation and a generous donation by Mrs. Sarah Beckwith (MPS 1985: 27, "History of St. Michael's Episcopal Church, Mt Pleasant, Iowa").

The 1920 Sanborn map shows this major work completed for St Michael Episcopal Church. The same footprint is shown for the original church building and the earlier rear addition at the southeast corner, with a larger rear addition then extending to the west. It extends about the same distance beyond the southwest corner as the earlier addition extends beyond the southeast corner, with the additions appearing to have been coordinated. The original church building and rear additions are all noted as frame construction, which is shown as clad in brick veneer. The earlier 1 ½ story frame house remains on the lot to the west, with an address of 200 E. Washington St.

The 1938 city directory lists St. Michael's Episcopal Church on E. Washington. The 1942 Sanborn map shows the same footprint for the church as the 1920 map, with the frame building clad in brick veneer.

The 1955 city directory lists St. Michael's Episcopal Church more specifically at 202 E. Washington St. The church continues to be listed at this address through the end of the 20th century.

The church was served by Rev. John Simpson-Atmore from 1957-1960, with a remodeling project completed on the interiors of the church and parish house in 1957 under the chairmanship of Dr. J. Stewart Jackson. Rev. Arthur P. Becker then served the church in 1961 to 1969 ("St. Michael's Parish organized in 1856," *Mt Pleasant News*, January 27, 1973, 4).

In 1961, St. Michael's Episcopal Church built new parsonage on the site to the west, replacing the house there that was noted as over 90 years old (see Iowa #44-02271) ("Parsonage and Rectory Built in Year," *Mt Pleasant News*, November 13, 1961, 18).

In 1967 a new Temple pipe organ was given in memory of J.M. Burd and was dedicated in a recital given by Mr. Carl Moehlman of Iowa Wesleyan College. ("History of St. Michael's Episcopal Church, Mt Pleasant, Iowa").

A memorial bequest from Mrs. Ruth Hayes was made several years before it was utilized. In 1987, Mr. Ernie Hayes worked with Rev. Wayne Kamm to erect a steeple and add electronic carillon bells to play

Iowa Site Inventory Form
State Historic Preservation Office
Continuation Sheet

Site Number: 44-02272
Related District Number: 44-02280

Page 5

St. Michael's Episcopal Church	Henry
Name of Property	County
202 E. Washington St	Mount Pleasant
Address	City

hymns for the public enjoyment in memory of his late wife, Ruth. Local architect, Barbara Welander, drafted specific plans and specifications for the steeple's construction, utilizing the carillon bells since the roof structure would not support cast bells. Father Kamm and local contractor H. Eugene Smith constructed the steeple. The new bell tower and steeple were lowered onto the roof and secured by H. Eugene Smith's construction company. The addition lends a voice to St. Michael's within the community ("Local church project features new steeple," *Mt Pleasant News*, August 7, 1987; "History of St. Michael's Episcopal Church, Mt Pleasant, Iowa").

The original stained glass windows were removed and restored by Bovard Studios in 2002 ("History of St. Michael's Episcopal Church, Mt Pleasant, Iowa").

The original stone foundation of the church was replaced in 2019. The original well remains in the undercroft which still has dirt floors ("History of St. Michael's Episcopal Church, Mt Pleasant, Iowa").

St. Michael's Episcopal Church continues to operate in their historic church building.

9. Major Bibliographical References

Building and sign permits, City of Mount Pleasant, Iowa

City and telephone directories, Mt Pleasant:

Bowron, Watson. *Henry County Directory for 1859-60*. Burlington, IA: Watson Bowron, 1859.

Annawalt & Lawrence's Bi-ennial Mt Pleasant Directory. Burlington, IA: Hawk-Eye Steam Printing House, 1867.

Annewalt, E.H., compiler. *Mount Pleasant City Directory*. Burlington: Daily Gazette, 1870.

Mount Pleasant City Directory for 1893. Mt. Pleasant, IA: Francis D. Craig, 1893.

Mason, George T. *Directory of Henry County, Iowa, 1911-12*. Mt. Pleasant, IA: The News, 1911.

Mount Pleasant Telephone Company. Telephone directories issued in 1913, 1915, 1918, 1921, 1925, 1927, 1937, 1939, 1944, 1948, 1950, 1952.

Groce, W.H. *The City Directory of Mt. Pleasant, Iowa*. Mt Pleasant: Groce, 1938.

Johnson Publishing Co. *Mt Pleasant, Iowa*. City directories issued in 1955, 1957, 1960, 1964, 1966, 1968, 1970, 1973, 1976, 1981, 1986, 1993, 2001, 2011. Manitowoc, WI: Johnson Publishing Co.

Cornerstones. Mt Pleasant: Mt. Pleasant Beautiful Committee, 1991.

Henry County Bicentennial Commission (HCBC). *The History of Henry County*. Dallas, TX: National ShareGraphics, Inc., 1982.

Henry County Historical Society. Vertical files and albums in files at Mt Pleasant Public Library.

Henry County Heritage Trust. Collection of historic images, in files and posted in Facebook albums. Collection in former Saunders School, Mount Pleasant, Iowa.

Henry County Recorder's Office / Henry County Auditor's Office. Property records, transfer books, and deed records. Henry County Courthouse, Mt Pleasant, Iowa

Iowa Site Inventory Form
State Historic Preservation Office
Continuation Sheet

Site Number: 44-02272
Related District Number: 44-02280

Page 6

St. Michael's Episcopal Church	Henry
Name of Property	County
202 E. Washington St	Mount Pleasant
Address	City

History of Henry County, Iowa. Chicago: Western Historical Company, 1879.

"History of St. Michael's Episcopal Church, Mt Pleasant, Iowa" Unpublished and undated history of the church in the collection of St. Michael's Episcopal Church.

Jaynes, Peter H., ed. *Highlights of Henry County History 1833-1976.* Burlington, IA: Doran & Ward Lithographing Co., 1977.

Koch, Augustus. *Birds-Eye View of the City of Mount Pleasant, Henry County, Iowa.* Chicago, IL: Merchants Lithographing Co, 1869. In collection of Henry County Heritage Trust and Mount Pleasant Public Library, Mount Pleasant, Iowa.

Mount Pleasant Beautiful. Mt Pleasant: Mt Pleasant News Company, 1909. Reprint issued in 1988.

Mount Pleasant, Iowa, Sesquicentennial, 1835-1985 (MPS). Mt Pleasant, IA: The Committee, 1985

Naumann, Molly Myers. *Architectural and Historical Resources of Mount Pleasant, IA.* National Register of Historic Places Multiple Documentation Form, May 1991. On file with the State Historic Preservation Office, Des Moines, IA.

Portrait and Biographical Album of Henry County, Iowa. Chicago: Acme Publishing Co., 1888.

Sanborn Map Company. *Mount Pleasant, Iowa.* Fire insurance maps for 1886, 1892, 1899, 1909, 1920, 1942. Library of Congress, Geography and Map Division, Sanborn Maps Collection.

Iowa Site Inventory Form

State Historic Preservation Office
Continuation Sheet

Site Number: 44-02272
Related District Number: 44-02280

Page 7

St. Michael's Episcopal Church

Henry

Name of Property

County

202 E. Washington St

Mount Pleasant

Address

City

Location map



Iowa Site Inventory Form
State Historic Preservation Office
Continuation Sheet

Site Number: 44-02272
Related District Number: 44-02280

Page 8

St. Michael's Episcopal Church

Henry

Name of Property

County

202 E. Washington St

Mount Pleasant

Address

City

Building footprint

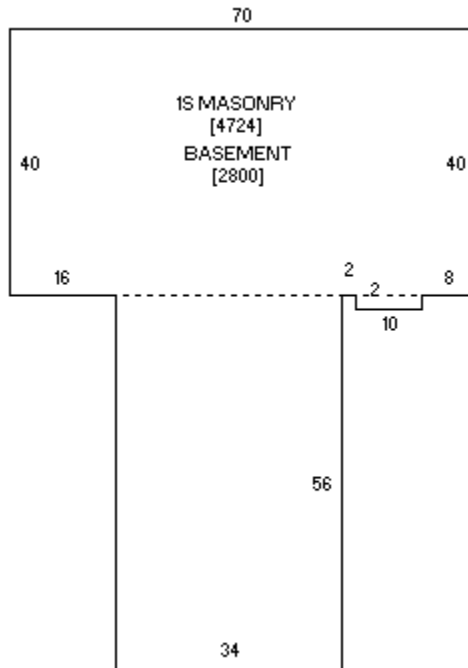

Sketch by www.camavision.com

Henry County Assessor (<https://beacon.schneidercorp.com>)

Iowa Site Inventory Form
State Historic Preservation Office
Continuation Sheet

Site Number: 44-02272
Related District Number: 44-02280

Page 9

St. Michael's Episcopal Church

Name of Property

Henry

County

202 E. Washington St

Address

Mount Pleasant

City

Historic images

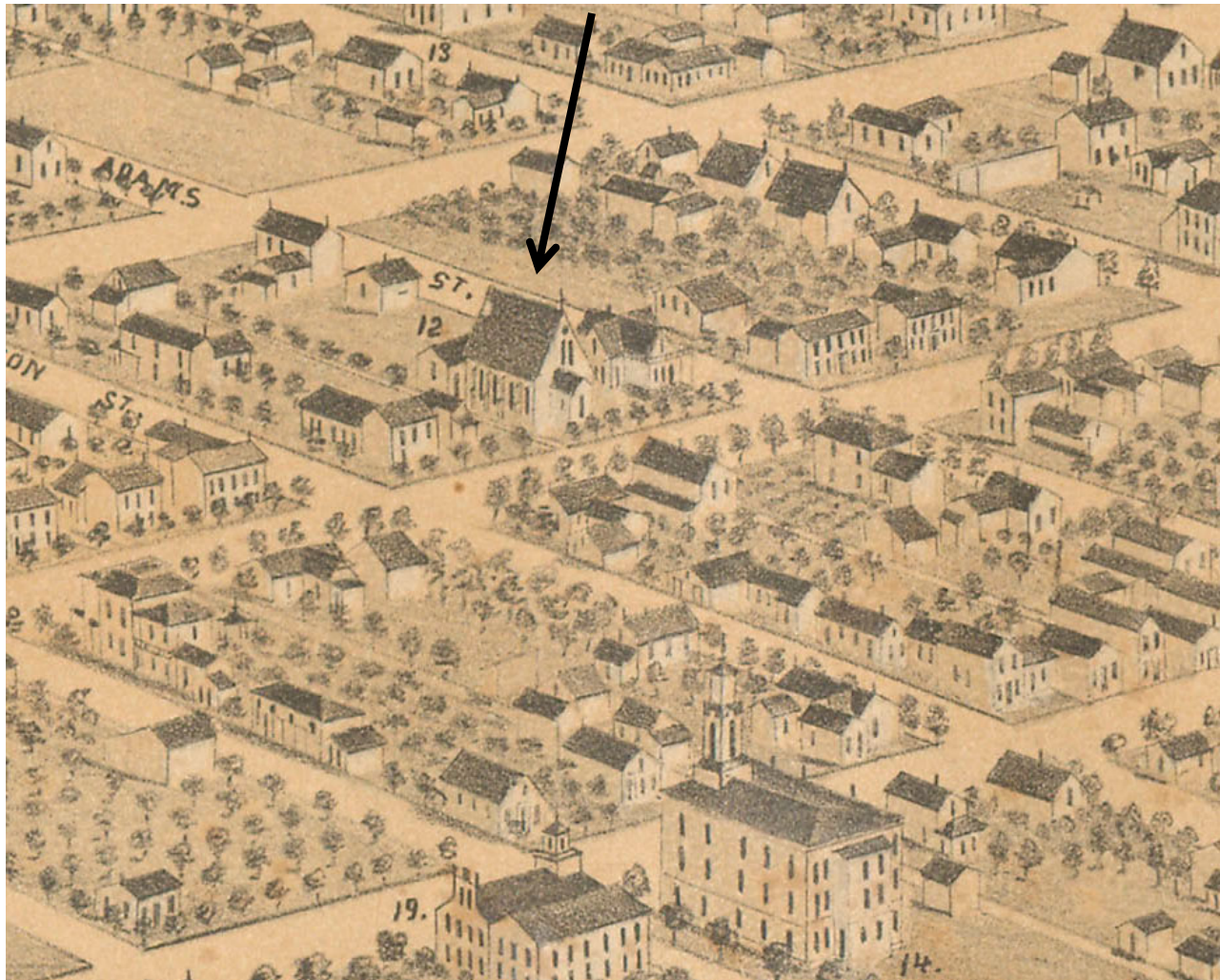

St Michael's Episcopal Church on 1869 birds-eye view of Mt Pleasant, looking southwest

Iowa Site Inventory Form
State Historic Preservation Office
Continuation Sheet

Site Number: 44-02272
Related District Number: 44-02280

Page 10

St. Michael's Episcopal Church

Henry

Name of Property

County

202 E. Washington St

Mount Pleasant

Address

City



ST. MICHAELS EPISCOPAL CHURCH AND RECTORY, E. WASH.

St Michael's Episcopal Church and rectory in 1909 (*Mt Pleasant Beautiful* 1909: 13)

Iowa Site Inventory Form
State Historic Preservation Office
Continuation Sheet

Site Number: 44-02272
Related District Number: 44-02280

Page 11

St. Michael's Episcopal Church

Name of Property

Henry

County

202 E. Washington St

Address

Mount Pleasant

City



St Michael's Episcopal Church after brick veneer added in 1917 (Hayes collection, HCHT files)

Iowa Site Inventory Form
State Historic Preservation Office
Continuation Sheet

Site Number: 44-02272
Related District Number: 44-02280

Page 12

St. Michael's Episcopal Church

Henry

Name of Property

County

202 E. Washington St

Mount Pleasant

Address

City



Episcopal Church
and Parish House

St Michael's Episcopal Church in 1938 city directory

Iowa Site Inventory Form
State Historic Preservation Office
Continuation Sheet

Site Number: 44-02272
Related District Number: 44-02280

Page 13

St. Michael's Episcopal Church
Name of Property

Henry
County

202 E. Washington St
Address

Mount Pleasant
City



**Rectory and church on east portion of 1947 aerial photograph of Mt Pleasant, looking north
(HCHT files, printed in *Des Moines Register*, April 27, 1947, sec 9, p3, p83)**

Iowa Site Inventory Form
State Historic Preservation Office
Continuation Sheet

Site Number: 44-02272
Related District Number: 44-02280

Page 14

St. Michael's Episcopal Church

Name of Property

Henry

County

202 E. Washington St

Address

Mount Pleasant

City

Digital photographs



Photograph 44-02272-001. North elevation, looking south (October 2023)

Iowa Site Inventory Form
State Historic Preservation Office
Continuation Sheet

Site Number: 44-02272
Related District Number: 44-02280

Page 15

St. Michael's Episcopal Church
Name of Property

Henry
County

202 E. Washington St
Address

Mount Pleasant
City



Photograph 44-02272-002. West elevation, looking east (October 2023)

Iowa Site Inventory Form
State Historic Preservation Office
Continuation Sheet

Site Number: 44-02272
Related District Number: 44-02280

Page 16

St. Michael's Episcopal Church
Name of Property

Henry
County

202 E. Washington St
Address

Mount Pleasant
City



Photograph 44-02272-003. West and south elevations, looking northeast (October 2023)

Iowa Site Inventory Form
State Historic Preservation Office
Continuation Sheet

Site Number: 44-02272
Related District Number: 44-02280

Page 17

St. Michael's Episcopal Church
Name of Property

Henry
County

202 E. Washington St
Address

Mount Pleasant
City



Photograph 44-02272-004. East elevation, looking southwest (October 2023)

Iowa Site Inventory Form
State Historic Preservation Office
Continuation Sheet

Site Number: 44-02272
Related District Number: 44-02280

Page 18

St. Michael's Episcopal Church
Name of Property

Henry
County

202 E. Washington St
Address

Mount Pleasant
City



Photograph 44-02272-005. South and east elevations, looking northwest (October 2023)